

BRICK
MANAGEMENT + LETTINGS



902 The Gateway 15 Trafford Road, Salford, M5 3NW

£995 Per month



902 The Gateway 15 Trafford Road, Salford, M5 3NW

£995 Per month

This spacious and well-presented ninth floor apartment is located in the sought after The Gateway development in the heart of Salford.

The property benefits from an entrance hallway with ample storage leading into a large open plan living room/dining area with wooden effect flooring and stylish white kitchen with integrated appliances. Also off the hallway is a spacious double bedroom and a separate luxury bathroom with shower.

Offered on a furnished basis with secure entry-phone access and neutral decoration throughout. The property also includes a secure, allocated parking space.

The Gateway development offers an onsite residents-only gym, 24-hour security and lift access to all floors. The property has 24/7 concierge which operate 7 days a week.

Description



Situation



Furnished

Council Tax Band: A

Available: 7th April 2026

Floor Plans

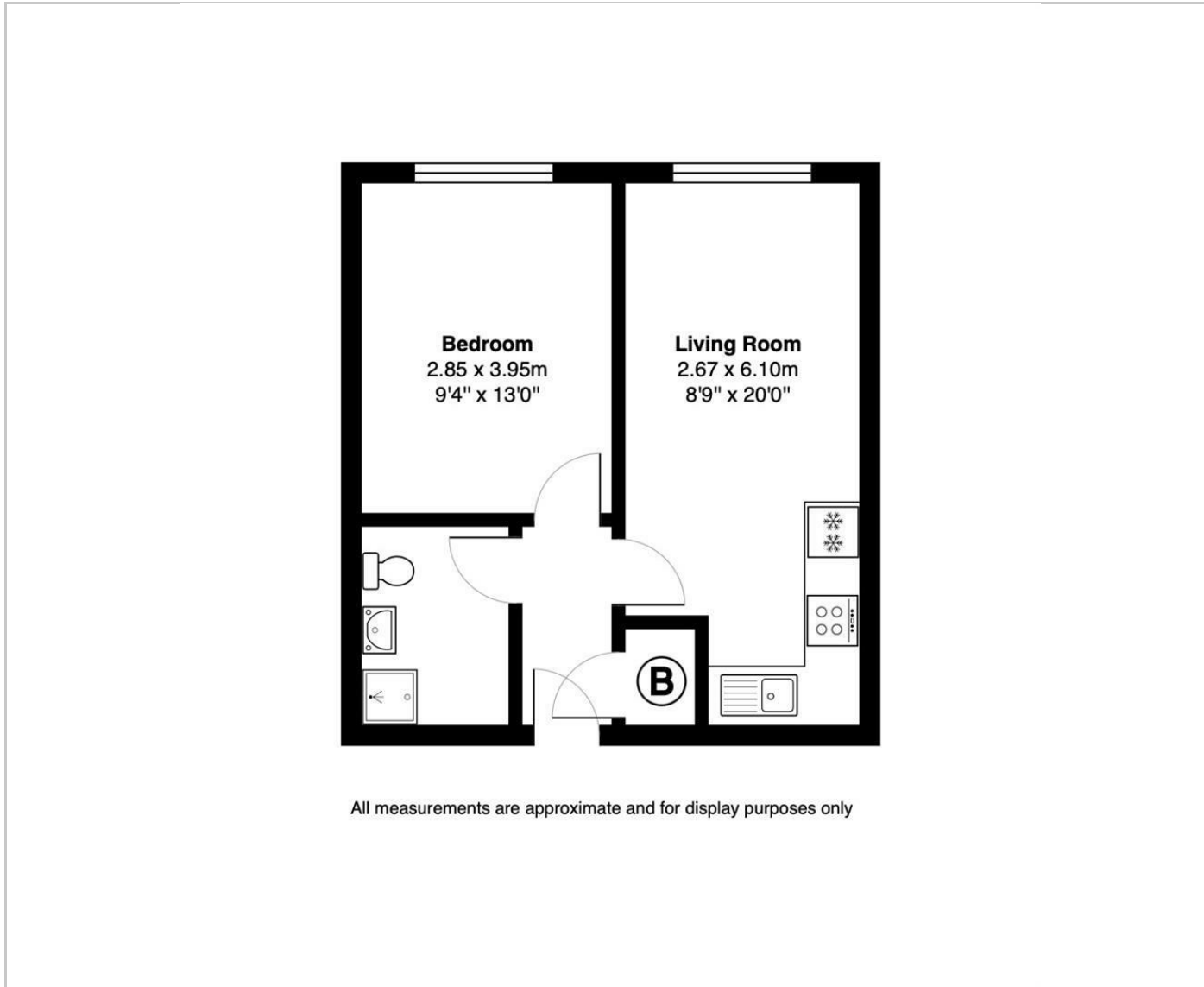

Area Map

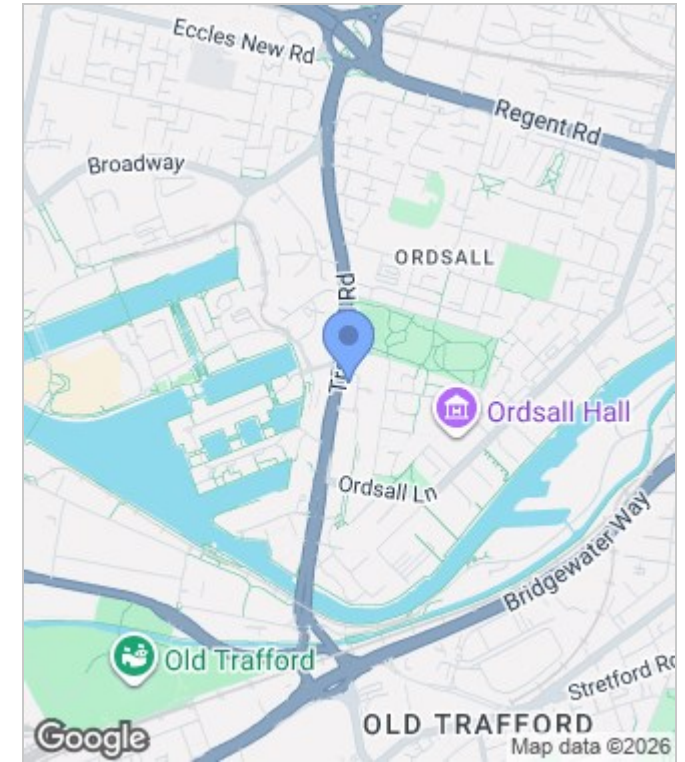

Energy Performance Graph

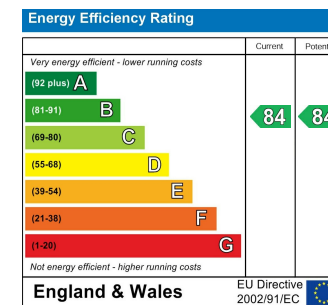

These particulars, whilst believed to be accurate are set out as a general outline only for guidance and do not constitute any part of an offer or contract. Intending purchasers should not rely on them as statements of representation of fact, but must satisfy themselves by inspection or otherwise as to their accuracy. No person in this firm's employment has the authority to make or give any representation or warranty in respect of the property.